

COMMERCIAL TRACT HWY. 707 2.8 ACRES NEAR HWY. 17 BYPASS

Auction Event - Premier Property
Wednesday, February 24, 2010, @ 10:00 AM
Hilton Garden Inn at Coastal Grand Mall
Registration Begins @ 9:00 AM

EXUM AUCTIONS AND REAL ESTATE

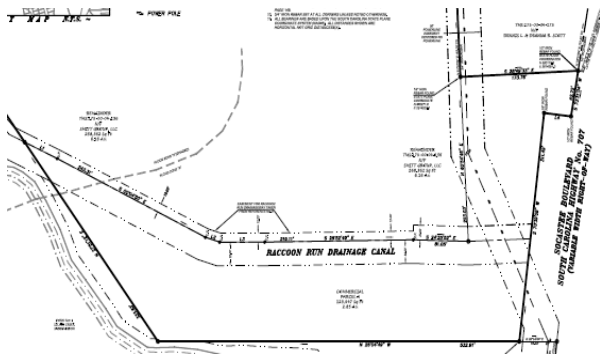

- ❖ *Commercial tract*
- ❖ *2.82 acre parcel*
- ❖ *Ready to build lot*
- ❖ *Hwy. 707 between Socastee and Hwy. 17 Bypass and the Market Commons area*
- ❖ *TMS 179-00-04-156*

Spring Creek Commercial Lot
Hwy. 707 and Lutie Road
Myrtle Beach, SC 29588

North side of Hwy. 707 just west of Computer store at Lutie Road.

Terms and Conditions of the Auction:

All Bidders should request and review an information package on or before the Auction event. Bidder packages contain required information to bid and buy at Auction.

Terms: \$10,000.00 deposit due at end of sale. Balance at closing on or before MARCH 31, 2010.

A 10% BUYER PREMIUM WILL BE ADDED TO THE FINAL BID PRICE.

Cooperating commissions of 3% offered to Brokers who properly register a client who becomes the successful Buyer.

All properties are sold "as-is, where-is, as-inspected.

All Bidders must sign and agree to abide by the Auction Terms & Conditions

All offers will be submitted to the Sellers and are subject to confirmation.

All interested parties should seek professional representation for assistance acquiring pertinent information regarding the property and inspecting the property to their total satisfaction.

Exum Auctions & Real Estate Services is acting as agents of the seller. Information provided is not guaranteed but has been provided by sources deemed reliable.

For More information visit www.ExumAuctions.com

843-222-9800

Joe Exum SCAL 2468 / BIC

Main Line: (843) 222.9800 Cell: (843) 457-4779

joe@exumauctions.com